

FA-X4T





CONTENTS

1. INTRODUCTION	5
2. UNPACKING	5
3. SAFETY	5
4. QUICK START	7
5. FA-X4T LAYOUT OF THE CONNECTOR PANEL	8
5.1 FI-X4T CONNECTION	10
6. FA-X4T BACK PANEL DESCRIPTION	11
6.1 AUDIO INPUT CONNECTOR WIRING	11
7. FA-X4T SYSTEM CONNECTION PLATE	12
8. SERVICE	13
10. SPECIFICATIONS	14



SYMBOLS



Frog declares that this device is in compliance with applicable CE standards and regulations. Before putting the device into operation, please observe the respective country-specific regulations!



Waste Electrical and Electronic Equipment (WEEE)
Please dispose of this product at the end of its operational lifetime by bringing it to your local collection point or recycling center for such equipment.



This symbol alerts the user to the presence of recommendations about the product's use and maintenance.



Warning: DANGEROUS VOLTAGE.
Terminals marked with this symbol carry a risk of electric shock, therefore external wiring connected to these terminals requires installation by a qualified professional or the use of ready-made leads or cords.



This symbol alerts the user to the presence of recommendations about product's use and maintenance.



This device complies with Restriction of Hazardous Substances Directive.

1. INTRODUCTION

The FROG-IS FA-X4T is the first choice for demanding musicians and DJs who work in loud environments.

A multi-purpose system (200 W), it is fully equipped to serve as a main PA, a stage monitor, a distributed audio system and also other applications. With a broad range of accessories and ultimate flexibility, it ensures a sound quality and intelligibility without compromise.

The FA-X4T delivers punchy, assertive sound. It's integrated; high performance delivers very high sound pressure levels with an exceedingly dynamic, tight and clean response. Loaded with top quality speakers, it provides premium audio performance with maximum reliability and minimum power compression that is easy to install.

This is a strong-built and robust system designed to handle high loads, rendering lead vocals, guitars, electronic instruments, and playback tracks with power and authority, easily delivering sound across medium-to-longer distances. The FA-X4T features provide musicians and audiences with an excellent acoustic experience, even on the most demanding stages.

2. UNPACKING

FROG-IS speakers are built to the highest standard and thoroughly inspected before leaving the factory. Upon arrival, carefully inspect the shipping carton, then examine and test your new product. If you find any damage, immediately notify the shipping company. Only the consignee may file a claim regarding the system's electronic equipment.

3.SAFETY



WARNING



Read all safety information below and operating instructions before using this device to avoid injury.

SAFETY AND HANDLING INFORMATION



Warning. Failure to follow safety instructions could result in fire, shock or other injury or damage

IT IS IMPORTANT THAT LOUDSPEAKER SYSTEMS ARE USED IN A SAFE MANNER.

Avoiding Hearing Damage. Professional loudspeakers are capable of producing extremely high sound levels and should be used carefully. Never stand close to loudspeakers driven at high volume. Set the volume to a safe level. You can adapt over time to a higher volume of sound that may sound normal but can be damaging to your hearing. Hearing loss get worse every time you're exposed to a sound level of 90 dB or over for an extended period of time. If you experience ringing in your ears or muffled speech, stop listening and have your hearing checked. The louder the volume, the less time is required before your hearing could be affected.

Avoiding Water and Wet Locations. Do not install the system in wet or humid locations without using weather protection. Take care not to spill any food or liquid on the device. In case it gets wet, unplug all cables, turn off the device before cleaning, and allow it to dry thoroughly before turning it on again. Do not attempt to dry the device with an external heat source, such as a microwave oven or hair dryer. A device that has been damaged as a result of exposure to liquids could be not serviceable. If the device is exposed to rain or excess moisture, unplug the power cord immediately.

Keeping the Outside Clean. Handle the device with care to maintain its appearance. To clean it, unplug all cables and turn off it. Warning: unplugging the power cord is the only way to disconnect power completely. Then use a soft, dry or slightly damp cloth. Avoid getting moisture in openings. Don't use window cleaners, household cleaners, aerosol sprays, solvents, alcohol, ammonia, or abrasives to clean the device.

Carrying, Handling and Installing the device. The device contains sensitive components. Do not drop, disassemble, open, crush, bend, deform, puncture, shred, microwave, incinerate, paint, or insert foreign objects into it. If your device has been dropped or damaged, or if liquid has been spilled into the chassis, unplug the power cord immediately.

Do not operate speakers for an extended period of time with sound distortion. This is an indication of malfunction, which in turn can generate heat and result in a fire.

To reduce the risk of overheating the device, avoid exposing it to direct sunlight and take care to do not install it near heat emitting appliances, such as a room heater or stove.

No naked flame sources such as lighted candles should be placed near the device.

Operate the device in a place where the temperature is between -20°C and 50°C (-4°F to 122°F). Avoid dramatic changes in temperature or humidity when using it, as condensation may form on or within the device.

During the use, it is normal for the device to get warm. The exterior of the device functions as a cooling surface that transfers heat from inside the unit to the cooler air outside.

The device should be placed so that its location does not interfere with its proper cooling. For example, the device shouldn't be placed on beds, carpets or similar surfaces that could create an obstacle for the ventilation openings.

To reduce the risk of electric shock, unplug the power cord before connecting audio cables.

Set up your device on a stable retaining horizontal surface. If combined or mechanically connected with other products, always verify the stability of the resulted system. Install the unit only in a location that can structurally support the weight of the unit, far away from people who can interfere with the stability of the system. In case of outdoor installation, assure that the wind does not interfere with the system's stability, taking extra securities like chains, weights, ropes or any other certified anchoring systems. Doing otherwise may result in the unit falling down, causing personal injury or property damage.

Protect the power cord from being walked on or pinched.

This audio system is not intended for use in the operation of nuclear facilities, aircraft navigation or communication systems, air traffic control systems, or for any other uses where the failure of the audio system could lead to death, personal injury, or severe environmental damage.

Do not make repairs yourself. Caution, risk of electric shock. Do not open the device, it contains potentially hazardous voltage. Never attempt to disassemble, repair or modify the system yourself. Disassembling the unit may cause damage that is not covered under the warranty. The device contains no user-serviceable parts. Repairs should only be performed by factory trained service personnel. Do not plug the power cord if you suspect that your device needs service or repair.

Choking Hazards. This device contains small parts, which may present a choking hazard to small children. Keep the device and its accessories away from small children.

4. QUICK START

When mounting a speaker onto any stand, always ensure that the stand is on a flat, level surface, with the legs fully extended. Be sure to check that the maximum load weight for the stands is greater than the weight of the ARRAY SYSTEMS loudspeaker. Never use a stand with a maximum load weight lower than the speaker. Do not attempt to mount more than one speaker on a stand at one time.

The ARRAY SYSTEMS loudspeakers are heavy. It is recommended that a second person to help place the cabinet on a stand.

When the speaker is placed on a stand, always check the integrity and center of gravity of the system. If the speaker can be tipped easily, or the pole is swaying, it is recommended that you lower the height of the stand. Position the stand and route cables so that the performers and the audience cannot tip over or trip on the system.

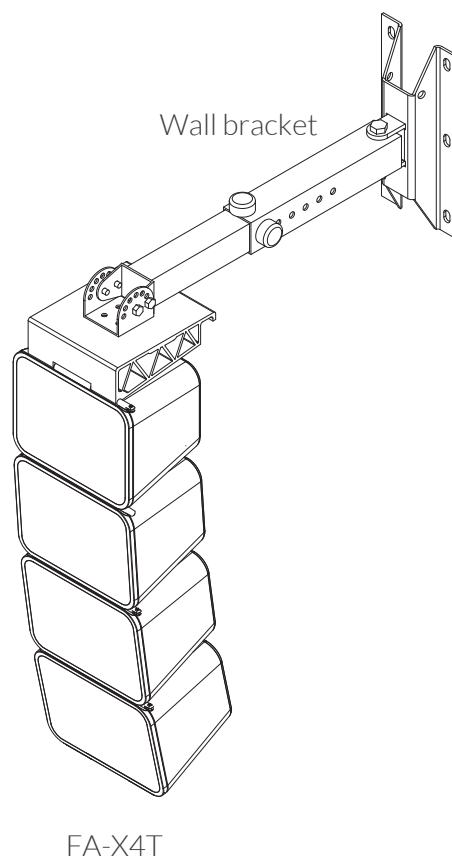

5. FA-X4T LAYOUT OF THE CONNECTOR PANEL

One module

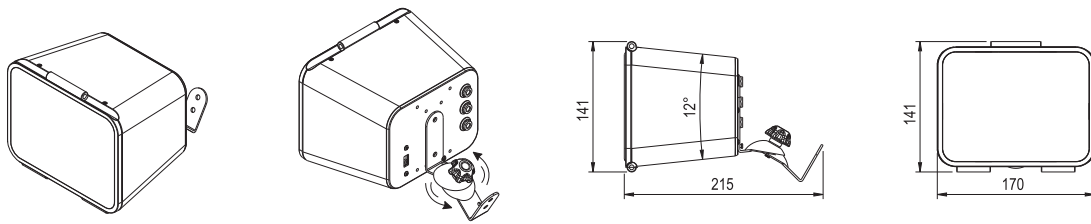

* Option wall bracket

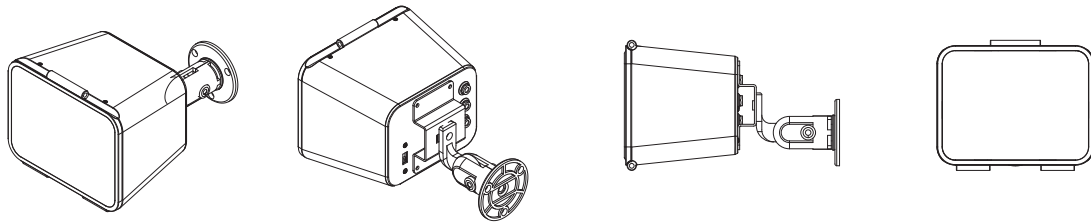

The direction of the bracket can be adjusted from any side.

More module

Versatile mounting options

Compared to many other speaker designs, the satellite Series is remarkably easy to install in several ways. It can be hung easily with chains, strong wires and cables using the accessory brackets.

There are also options for hanging with a pre-install frame by itself or configured with a subwoofer.

There are also other options including ceiling and wall brackets as well as an adapter for use with a dedicated stand.

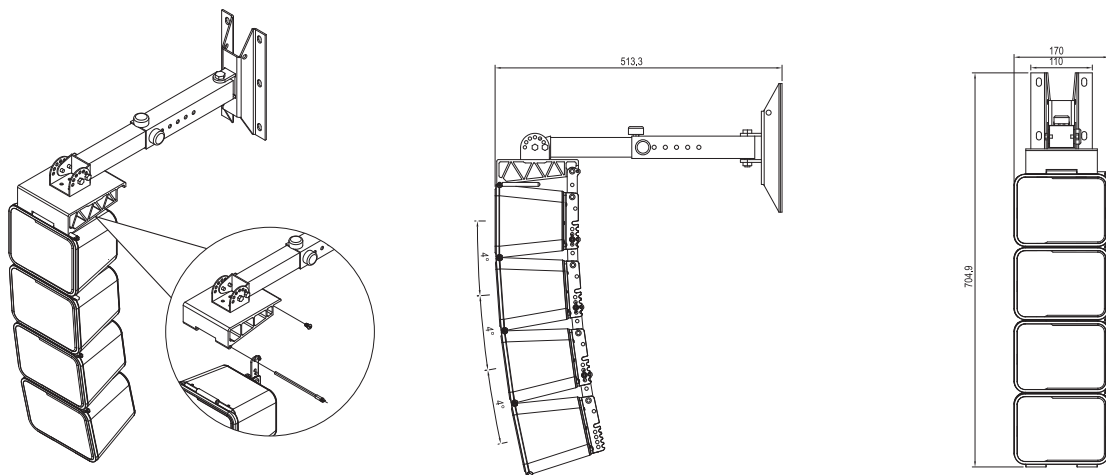

The bracket support wall and ceiling mounting with most 8 modules .
The direction and angle can be adjusted from any side.

Connect Manner

- 1) Align two units to make the latch hole in the same line. Insert the latch and lock the screw tightly.
- 2) Adjust the angles of the unit (four angles: 0°-4°-8°-12° can be adjusted), insert the rear connecting pin into the related slot and put the latch into the hole.

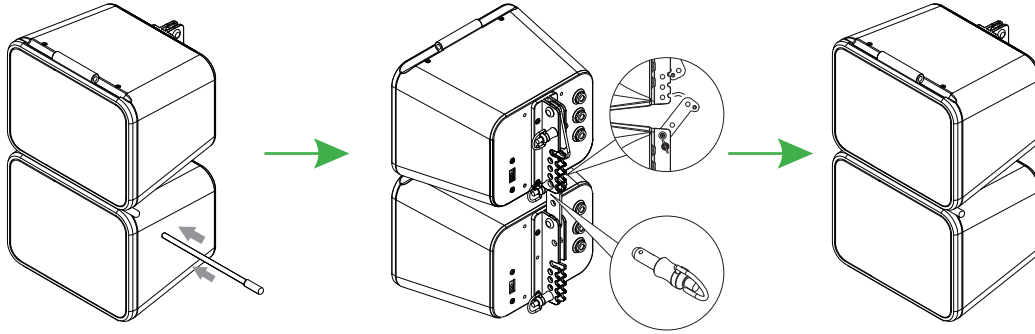

You can insert each three different holes when connecting the rear bracket. You can obtain different sound by different angles.

Adjustable sound dispersion(for example four pcs)

A system is configured by vertically stacking four speaker modules with a total driver complement of four woofers and 12 tweeters positioned along the baffle surface, this configuration allows the variable directivity control and low-frequency dispersion control comparable to using a large constant-directivity horn speaker. A choice of three directivity angles---0, 4, 8 and 12 degrees can be employed as needed.

For instance, a specific directivity angle, or each module can have its directivity independently set for a specific coverage requirement. When two or multiple modules are connected to configure an arc, they effectively function as an immense single speaker controlling directivity for considerably lower frequencies. As a result, public address functions demonstrate optimal intelligibility even in environments with long reverb times.

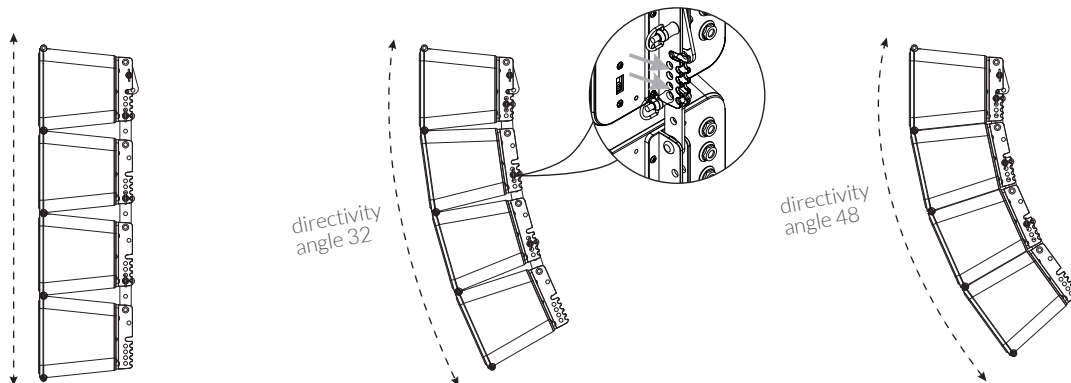

Minimal reflective effects

Whether mounted on the wall or ceiling, the satellite is remarkably free from the comb filter and interference effects often encountered with other speaker designs. It can therefore produce more low frequency output even when mounted on the wall or ceiling.

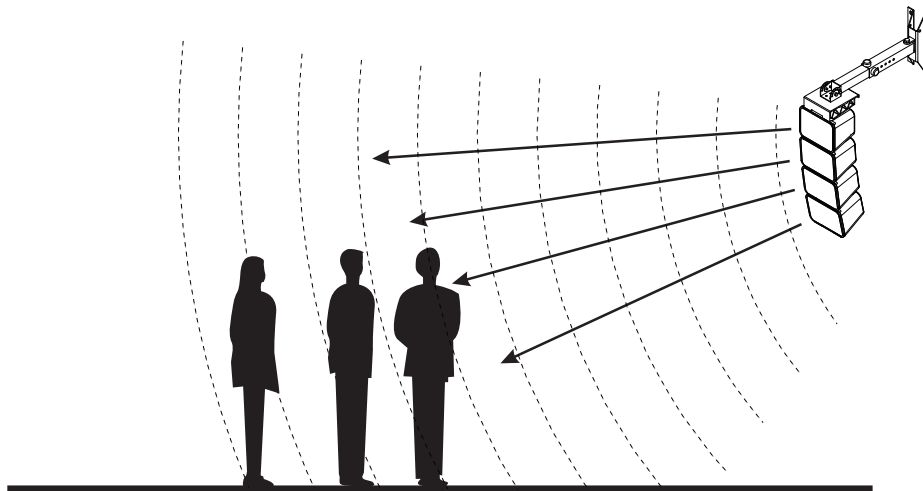

5.1 FI-X4T CONNECTION

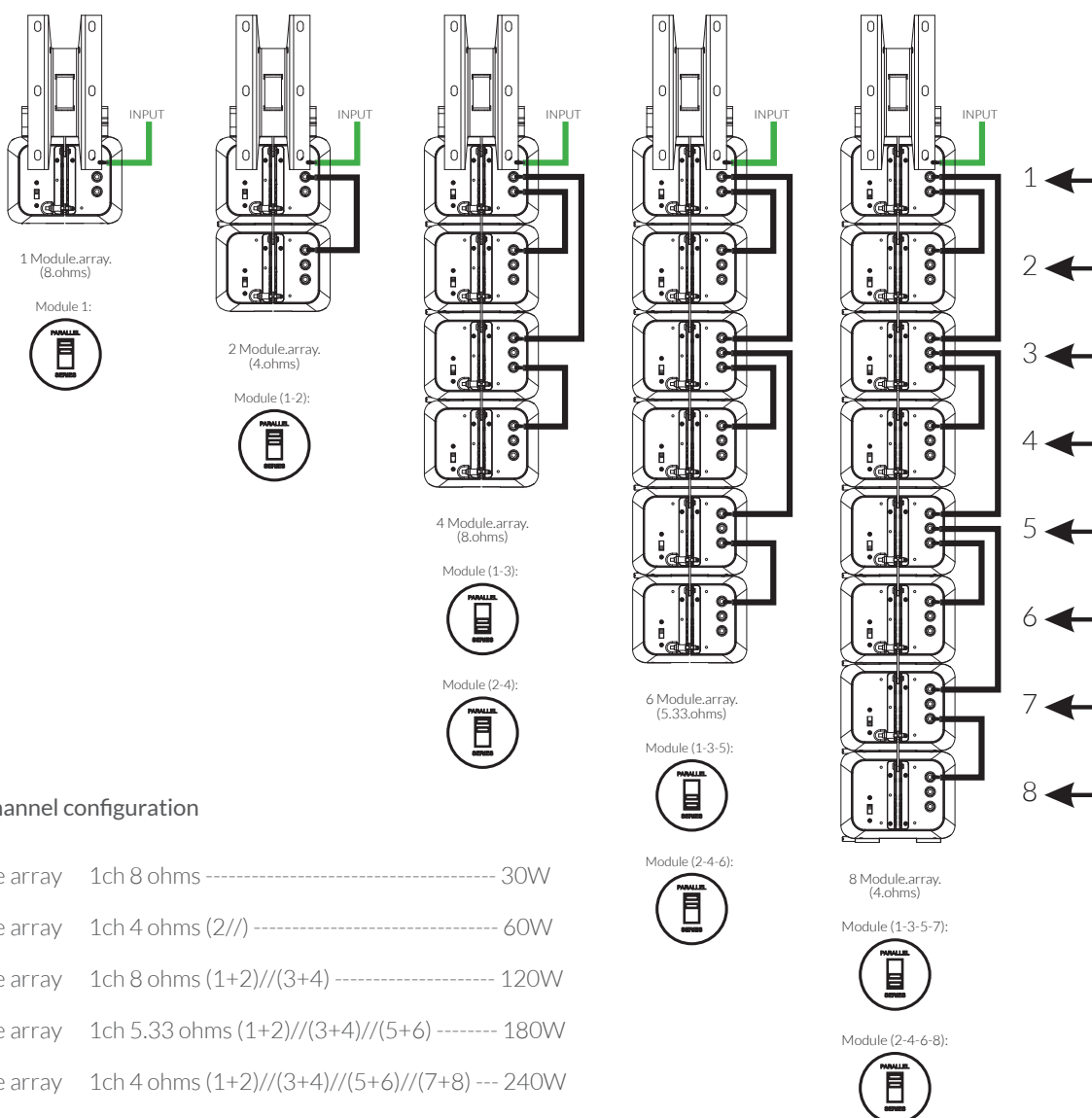

6. FA-X4T BACK PANEL DESCRIPTION

1) INPUT: Receive the power coming from an external power amplifier.

2) PARALLEL: power output for another product to parallel, parallel and input are link.

3) SERIES: Power output for another satellite speaker to series.

4) Slide Switch: Parallel or Series Transform Switch

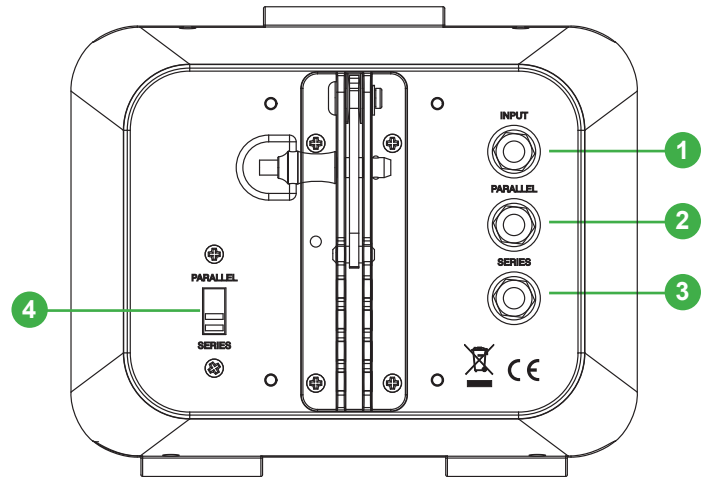

a. set the slide switch at "parallel" position to make the product in parallel.

b. Set the switch at "series" position to make products in series, but the slide switch of the last product has to set at "parallel" position.

6.1 AUDIO INPUT CONNECTOR WIRING

The series speaker connections are made via the rear panel 1/4" connectors for easy interface with industry standard cables. Standard, unshielded speaker wire (available at your local pro audio or music store), with either 1/4" phone connectors and wire gauge of 12-14 AWG is recommended.

If your amplifier uses binding posts you can use speaker cables with banana connectors, but be sure to pay attention to the +/- polarity when making the connections. Make sure that the + terminal of the speaker, or banana connector, is connected to the + terminal of the power amplifier, and that the - terminal of the speaker, or banana connector, is connected to the - terminal of the power amplifier. It is important that your PA system is connected in-phase, otherwise you will not have the proper low-end response and stereo image.

Use the following diagrams below to ensure proper connections when wiring your system:

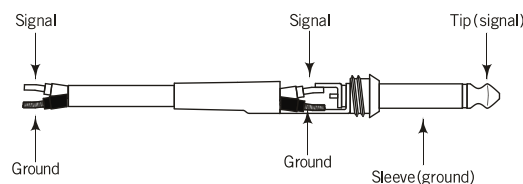

7. FA-X4T SYSTEM CONNECTION PLATE

Make your initial connections with all the equipment powered off, and ensure that all the main volume controls are turned completely down.

For Passive Full-range Speaker Cabinet

- 1) Connect one side of the speaker cable to the Output CH A / CH B to Binding Post of your stereo power amplifier and the other side to the Input socket of your speaker cabinet.
- 2) Complete other connections as illustrated.
- 3) Turn up your mixer first, then the stereo power amplifier.
- 4) Turn up the volume controls of your amplifier to about 70%.
- 5) Use PFL function to get the proper input level for the mixer, and adjust the Main Mix Level control to manipulate the output level.
- 6) After using, turn off your stereo power amplifier first, then the mixer.

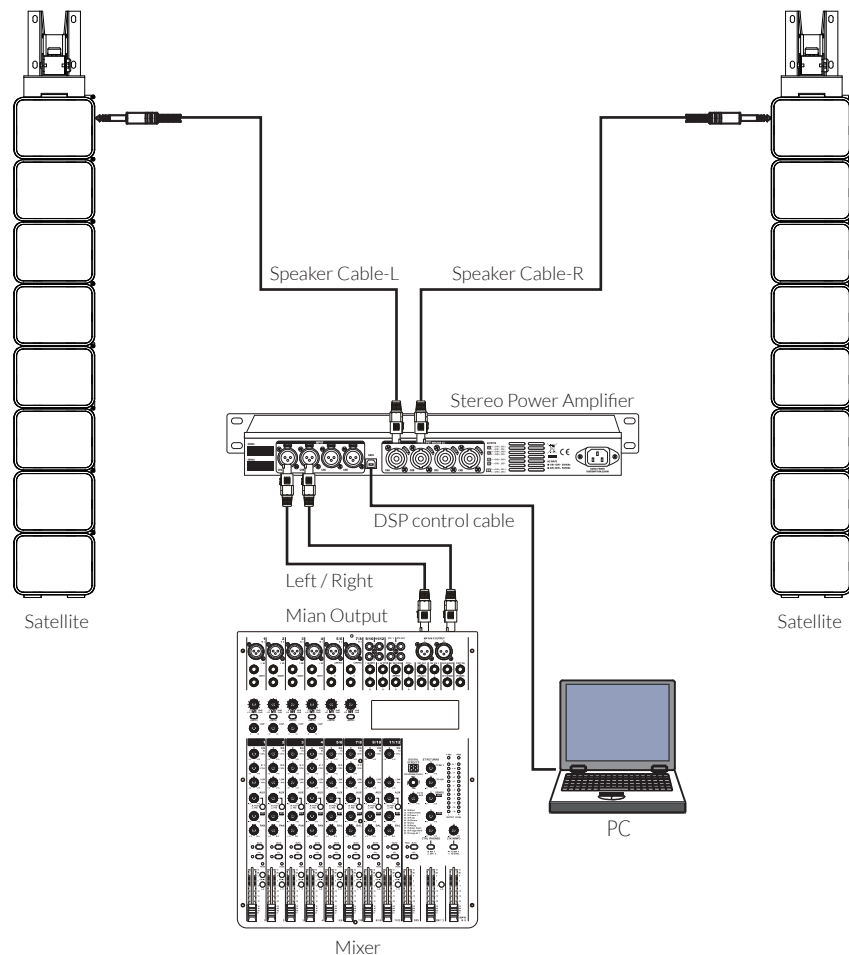

8. SERVICE

To obtain service:

- 1) Contact the official Frog distributor in your country. Your local distributor will direct you to the appropriate service center.
- 2) If you are calling for service, please have the serial number(s) of the unit(s) available for reference. Ask for Customer Service, and be prepared to describe the problem clearly and completely.
- 3) If the problem cannot be resolved over the phone, you may be required to send the unit in for service. In this instance, you will be provided with an RA (Return Authorization) number which should be included on all shipping documents and correspondence regarding the repair. Shipping charges are the responsibility of the purchaser.

Any attempt to modify or replace components of the device will invalidate your warranty. Service must be performed by an authorized Frog service center.



Cleaning:

Use only a soft, dry cloth to clean the product. Do not use any solvents, chemicals, or cleaning solutions containing alcohol, ammonia, or abrasives. Do not use any sprays near the product or allow liquids to spill into any openings.

10. SPECIFICATIONS

	Acoustic parameters
Frequency Response	100Hz-20KHz(-10dB)
Sensitivity(1W/1m)	90dB
Maximum SPL	103dB
Impedance	8 ohms
	Coverage
Horizontal	120°
Vertical	20°
Attachment Points	Adjustable Rigging system & Vertical Splay in 0°- 4°- 8°- 12°increments from 0°- 12°
	Drivers
Mid-low Driver @Impedance	1x4" Neodymium woofer with 1" Voice Coil @8Ω
Tweeter @Impedance	3 x Neodymium Tweeter with 0.5" Voice Coil @8Ω
	Power
Max Power	120W
Rate Power	60W
	Crossover
Type	Build-in Crossover
Crossover Frequency	3.0Khz
	Physical
Parallel or Series	6.3mm Socket / Selection Switch
Weight	1.46Kg / 3.22 lbs
Dimensions (HxWxD)	141 x 170 x 162 mm / 5.55" x 6.69" x 6.38"





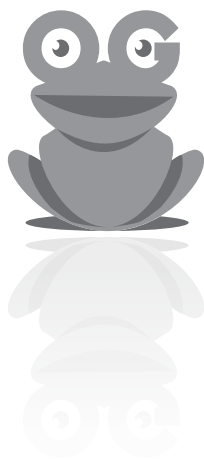

FROG-IS

WWW.FROG-IS.COM

FROG-IS is a brand of K-gear surl - Via Paolina Romagnoli 17, 50038 Scarperia e San Piero, Firenze
ITALY

